

# DRED INSTALLATION INSTRUCTION

1.

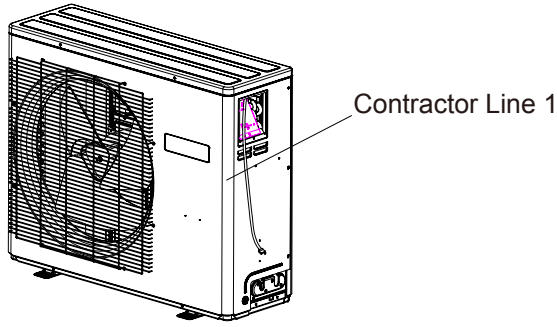

Open cover piece and locate the fixed DRM cable.

2.

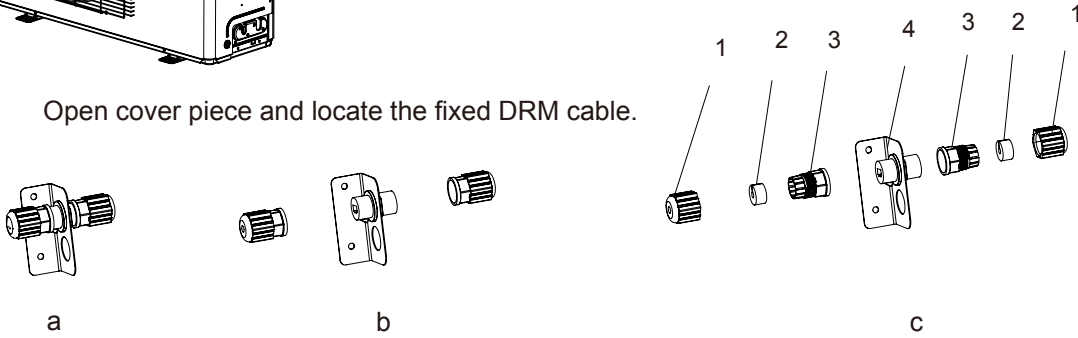

- Take out DRED module from indoor packing bag.
- Separate DRED module to 3 parts as shown.
- Continue to separate the DRED module to 7 parts as shown.

3.

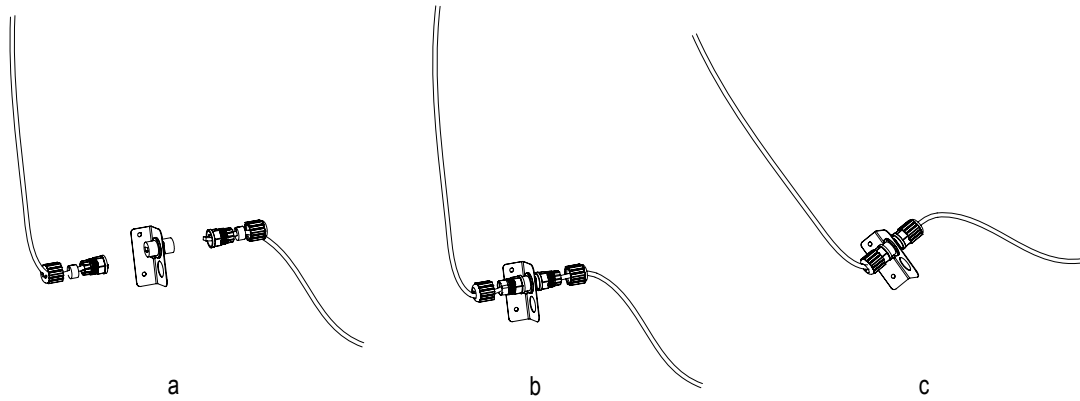

- Fix Pin 1 for contractor supplied line through nut 1, seal ring 2, tapered cup nut 3 insert to stud 4.
- Repeat step 1 for fixed DRM line.
- Tighten the screw position on both sides.

4.

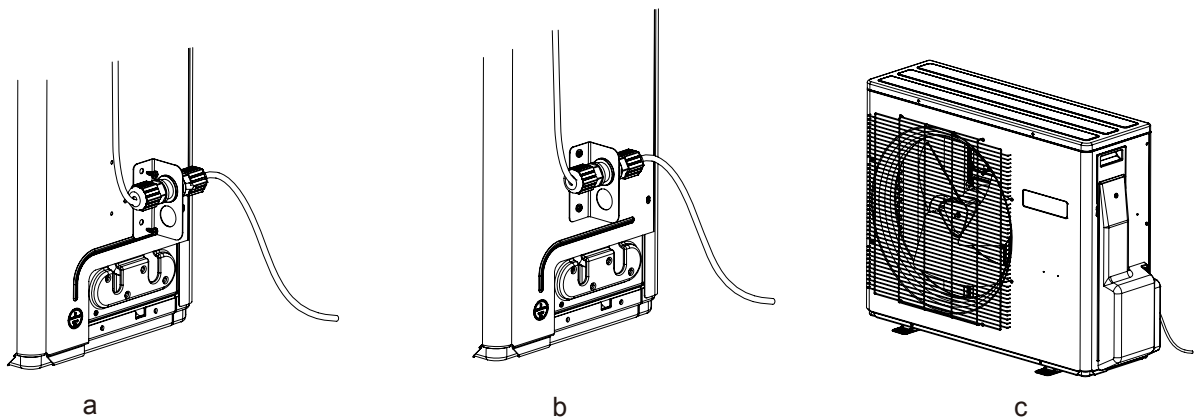

- Tighten the DRED module to right side plate.
- Tighten the screw .
- Refit the trim cover.